

# STYLE 10 SWIVEL

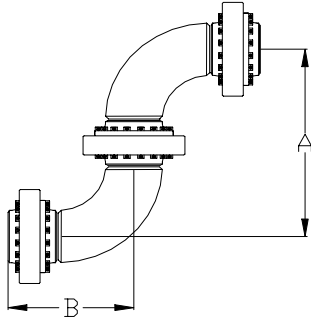

- All dimensions and weights are approximate.
- Dimensions noted in inches, weight in pounds.

██████████ Consult factory for further details

Size	D2000			D1070			D2001		
	"A"	"B"	Weight	"A"	"B"	Weight	"A"	"B"	Weight
2"	9.86"	6.86"	40.25	11.31"	8.31"	33.2	11.31"	8.31"	57.2
3"	12.86"	8.36"	57.21	14.75"	10.25"	60.6	14.75"	10.25"	60.6
4"	15.86"	12.86"	78.64	19.19"	13.19"	101.8	19.19"	13.19"	101.8
6"									
8"									
10"									
12"									
16"									
20"									
24"									

Size	D0002			D1010			D0116		
	"A"	"B"	Weight	"A"	"B"	Weight	"A"	"B"	Weight
2"							6.13"	8.31"	10
3"							8.38"	10.25"	20
4"							9.31"	13.19"	25
6"	24.3"	15.3"	174	27.65"	18.65"	273			
8"	31.09"	19.09"	314.6	34.83"	22.83"	458.6			
10"	37.87"	22.87"	484.8	40.43"	25.43"	661.8			
12"	44.66"	26.66"	717	47.65"	29.65"	1086			
16"	57"	33"	1141	60.01"	36.01"	1570			
20"				72.83"	42.83"	2223			
24"									

## End Connections

Size	150# Flange		Female NPT	
	OAL	Weight	OAL	Weight
2"	2.5"	9	1.3"	0.7
3"	2.75"	14	1.5"	1.6
4"	3"	16	1.7"	3.1
6"	3.5"	25		
8"	4"	40		
10"	4"	56		
12"	4.5"	86		
16"	5"	141		
20"	5.69"	188		
24"	6"	270		